

## Standard/Metric DWL Expanding Dowels

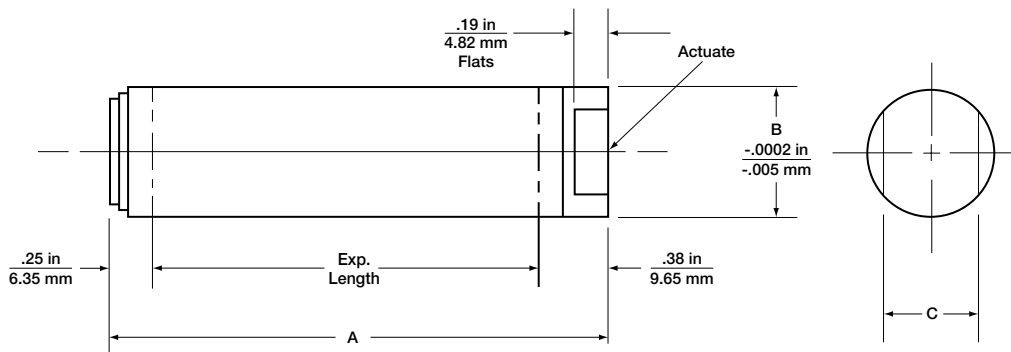

DOWEL NO.	A (in)	A (mm)	B	C	EXPANSION
DWL. 50-225	2.25	57.1	.500 in 12.7mm NOM.	.44 in 11.1 mm	.0015 in .0381 mm
DWL. 50-250	2.50	63.8			
DWL. 50-275	2.75	69.8			
DWL. 50-300	3.00	76.2			
DWL. 50-325	3.25	82.5			
DWL. 50-350	3.50	88.9			
DWL. 56-225	2.25	57.1	.562 in 14.27 mm NOM.	.50 in 12.7 mm	.0017 in .043 mm
DWL. 56-250	2.50	63.8			
DWL. 56-275	2.75	69.8			
DWL. 56-300	3.00	76.2			
DWL. 56-325	3.25	82.5			
DWL. 56-350	3.50	88.9			
DWL. 62-225	2.25	57.1	.625 in 15.8 mm NOM.	.50 in 12.7 mm	.0019 in .048 mm
DWL. 62-250	2.50	63.8			
DWL. 62-275	2.75	69.8			
DWL. 62-300	3.00	76.2			
DWL. 62-325	3.25	82.5			
DWL. 62-350	3.50	88.9			
DWL. 75-300	3.00	76.2	.750 in 19.0 mm NOM.	.62 in 15.7 mm	.0023 in .058 mm
DWL. 75-325	3.25	82.5			
DWL. 75-350	3.50	88.9			
DWL. 75-375	3.75	95.2			
DWL. 75-400	4.00	101.6			
DWL. 75-450	4.50	114.3			

DOWEL NO.	A (in)	A (mm)	B	C	EXPANSION
DWL. 87-300	3.00	76.2	.875 in 22.2 mm NOM.	.75 in 19.0 mm	.0026 in .066 mm
DWL. 87-325	3.25	82.5			
DWL. 87-350	3.50	88.9			
DWL. 87-375	3.75	95.2			
DWL. 87-400	4.00	101.6			
DWL. 87-450	4.50	114.3			
DWL. 100-300	3.00	76.2	1.000 in 25.4 mm NOM.	.81 in 20.5 mm	.003 in .076 mm
DWL. 100-325	3.25	82.5			
DWL. 100-350	3.50	88.9			
DWL. 100-375	3.75	95.2			
DWL. 100-400	4.00	101.6			
DWL. 100-450	4.50	114.3			
DWL. 112-300	3.00	76.2	1.125 in 28.5 mm NOM.	.88 in 22.3 mm	.003 in .076 mm
DWL. 112-325	3.25	82.5			
DWL. 112-350	3.50	88.9			
DWL. 112-400	4.00	101.6			
DWL. 112-450	4.50	114.3			
DWL. 112-500	5.00	127			
DWL. 125-300	3.00	76.2	1.250 in 31.7 mm NOM.	1.00 in 25.4 mm	.003 in .076 mm
DWL. 125-325	3.25	82.5			
DWL. 125-350	3.50	88.9			
DWL. 125-400	4.00	101.6			
DWL. 125-450	4.50	114.3			
DWL. 125-500	5.00	127			

**Note: When ordering please specify hole size and Tolerance. "B" Diameter will be supplied .0002 under hole size.**